

Under Bench – Reverse Osmosis

Direct Flow System with Designer Tap

APPLICATIONS

- ◆ Point-of-use drinking water
- ◆ Under bench installations

GENERAL INFO

Introducing the latest in Reverse Osmosis technology. The all-new HRV Direct Flow RO has been designed with space saving in mind. It also uses Direct Flow technology, so no additional storage tank is required. Direct Flow technology also means you have access to pure RO water on tap at all times – so no running out of water or waiting for a storage tank to refill. The RO water is delivered through our commercial grade “Stainless Steel” tap, which operates with a simple easy quarter turn.

The new HRV Direct Flow RO includes a high-recovery Reverse Osmosis encapsulated membrane with a 1:1 pure water ratio, ensuring high performance and water saving. The system also includes a poly spun and carbon block pre-filter, designed to reduce sediment, chlorine and odour, and improve the overall taste. This also helps prolong the life of the RO membrane.

The RO membrane separates water molecules from dissolved salts and minerals, producing high quality and great-tasting drinking water.

Invest in an HRV Direct Flow RO system and drink cleaner, purer, better-tasting water today!

STAINLESS STEEL DRINKING TAP - INNOVATIVE DESIGN

- ◆ Contains no toxic substances in sections that have contact with water
- ◆ Body constructed of stainless steel material
- ◆ Automated manufacture to increase the accuracy of quality control
- ◆ All products have a smooth 360° swivel
- ◆ Mounting hardware is included



FEATURES | BENEFITS

- ◆ Smart LCD technology to show cartridge life, operation and TDS (total dissolved solids)
- ◆ Water saving 1:1 pure water ratio vs 4:1 traditional RO technology
- ◆ Innovative new design with integrated waterboard to ensure high performance
- ◆ Under bench slim 500G RO with quick change filter technology
- ◆ Unique space-saving “super slim” design with ABS cover
- ◆ No additional post filter, i.e. extra cost, required
- ◆ Includes auto leak stop valve to reduce flood risk
- ◆ Easy access for filter replacement and serviceability
- ◆ High quality water on demand and at your fingertips
- ◆ Reduces salts, dissolved minerals, and bad taste and odour
- ◆ Designed for chlorinated and non-chlorinated potable drinking water. Bore and other non-chlorinated water, subject to water analysis
- ◆ 3/8” tubing from the system to the tap for high flow

SMART PURIFIER DISPLAY

Inlet Water TDS: Indicates the incoming Water Quality

Outlet Water TDS: Purity of Drinking Water

Purify: Smart Purifier in Operation

Rinse: In Rinse Operation

Leak: Leak detection alert

Fault: Fault detection alert

PP+C, RO, T33: Indicates the life of the relevant Filter Cartridge and provides alert when replacement should occur

Under Bench – Reverse Osmosis

Direct Flow System with Designer Tap

SERVICING REQUIREMENTS

DESCRIPTION	SERVICING FREQUENCY
Stage 1: PP+Carbon Filter	6 months
Stage 2: RO Membrane	18 months
Stage 3: T33/Coconut Carbon Cartridge	12 months

NOTE: The cartridge replacement time is a guide and based on typical mains water quality and usage.

REVERSE OSMOSIS PRINCIPLE OF OPERATION

FROM TAP WATER TO PURE WATER

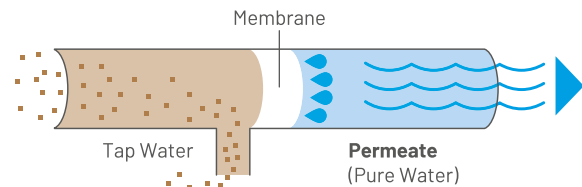

Concentrate
(Water with impurities out to drain)

■ Total Dissolved Solids (TDS)

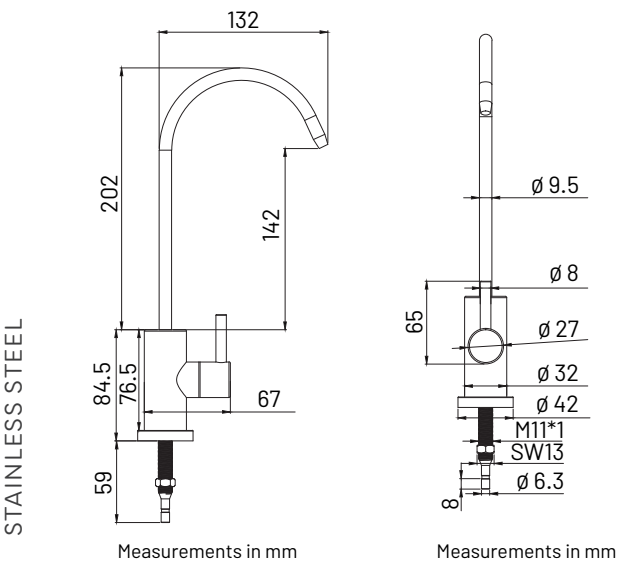

SPECIFICATIONS & PERFORMANCE

Rated Voltage & Frequency

100V - 240V ~ 50/60Hz

Rated Power

60 W

Inlet Water Pressure

14.5 psi - 58.0 psi

Filtered Water Rate*

2.0 lpm

Purified Water Rate

1.3 lpm

Rated capacity of Purified Water

2000 litre

Applicable conditions

Temperature: 4-40°C

Ambient humidity: below 90%

Water Source

Municipal Water (Can be used on other water source subject to water analysis/other pre-treatment)

Product Size

443 mm (Depth) x 132 mm (Width) x 356 mm (Height)

NOTE: * Filtered Water Option applies to Dual/Tri-Flow Faucets only.